

55	导草板	tongue	0195F48PH02	PP(AW191)		1	
56	螺钉	bol t	J0010000673R		M4*10	2	
57	调高盖	move cover	0195K28F860	PP		1	
58	调高板簧	move spring	J1970370001R			1	
59	调高手柄	move flap	0195F280874R	POM		1	
60	机体下盖	deck cover	0195D49P860	PP(AW191)		1	
61	调高轴	move axes	0197D540H10R	POM		2	
62	调高拉簧	move spring	J1970690001R	70C		1	
63	刀片	bl ade	J2420000084R	40Mn		1	
64	垫片	washer	J0030000019R	65Mn		1	
65	螺栓	bol t	J0020000088R	40Mn	M8*20	1	
66	转轴压板	washer	J0220000088R			4	
67	前轮轴	front wheel axes	J0090000290R	Q235		1	
68	配重块	bl ock	01954270H18R	水泥块		1	

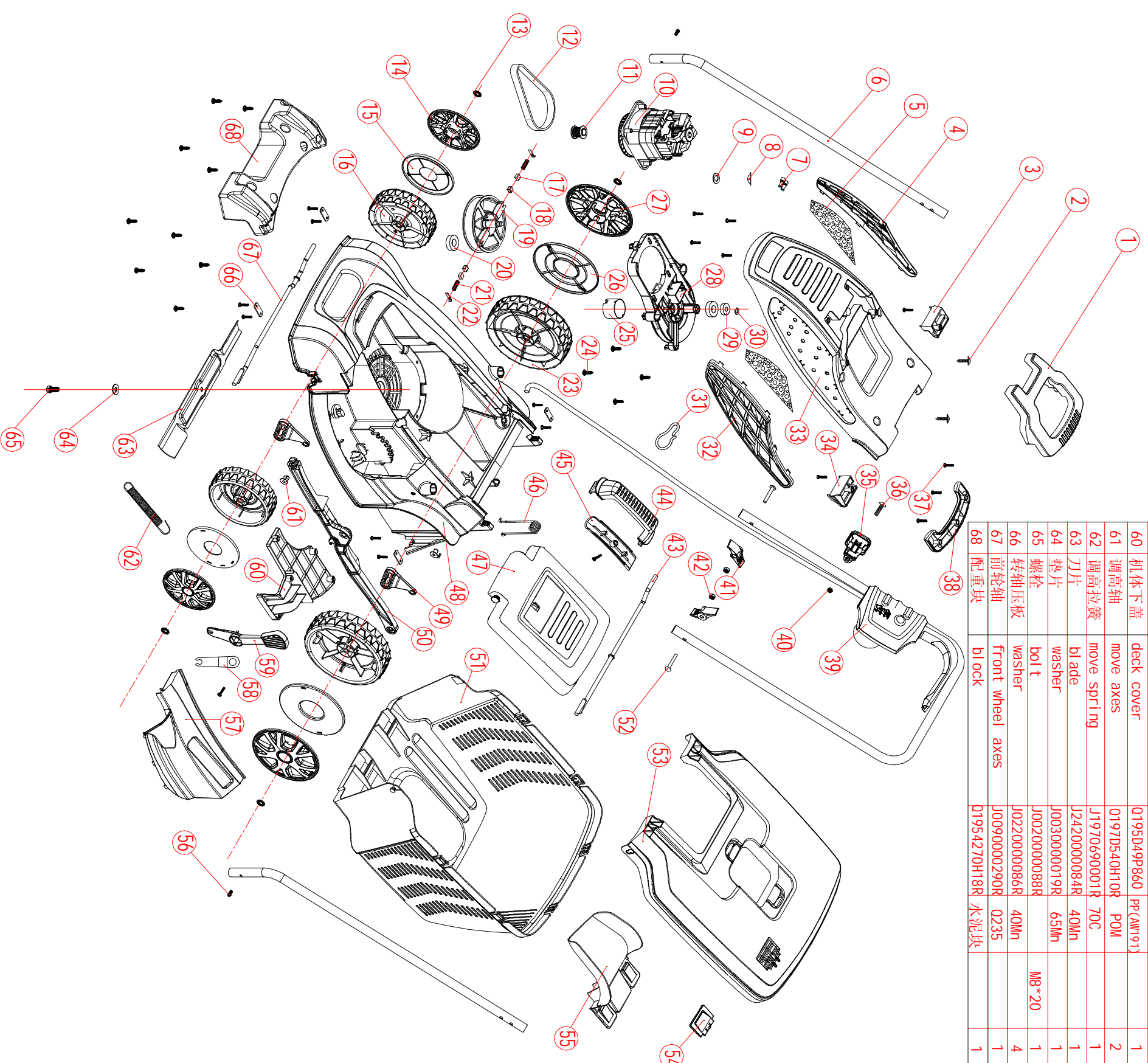

序号	零部件名称	零部件英文名称	ERP编码	材料	规格	数量	备注
1	上盖手柄	safety flap	0195Z59P613	PP		1	
2	自攻螺钉(镀锌)	bol t	J0010001022R	PP	ST4*16	8	
3	右盖上盖压块	Right cover washer	0195765PH02	PP		1	
4	右装饰片	Right decorate cover	0195D29A613	ABS		1	
5	过滤海绵	Filter	G1950220001	二次发泡		2	
6	下推杆	Lower handle	J2470000043R		0195	2	
7	压接帽	impaction cup	D5000100004R			2	
8	内齿卡圈	star lock	J0150000998R		Ø4.5	1	
9	垫片	washer	J0200000112R	红钢纸		1	
10	电机	motor	2A690020R		0043GCB	1	
11	小带轮	motor pulley	J2510000002R	45#		1	
12	多楔带	bel t	X6360940002R		7PJ451	1	
13	轴承夹	star lock domed	J0320000015R	65Mn/φ8		4	
14	行走轮盖-140	wheel cover	0197A39P613	PP		2	
15	轮盖镶片-140	wheel cover beset	01977460H02	PP		2	
16	行走轮-140	wheel	0197D680H02	PP		2	
17	刹车铁块	bl ock brake	J4390000001R	08F		2	
18	刹车片	cor k brake	Z0470000001	软木		2	
19	带轮组件	pulley insert mould	A6362040001R			1	
20	轴承	bearing	J0160000065R	6002		2	
21	刹车弹簧	spring brake	J6330680001R	70C		2	
22	插片	patch brake	J0130000023R	40Mn		2	
23	后行走轮	wheel	0195F29PH02	PP		2	
24	螺丝非标	bol t	J0010000896R		ST5*20	9	
25	刹车环	ring brake	J4380000001R	0195		1	
26	后轮盖镶片	Back wheel cover beset	0195421PH02			2	
27	后行走轮盖	wheel cover	0195F29P613	PP		2	
28	电机支座	motor plate	06360961B49R	PA66-GF50	609 Z	1	
29	轴承	bearing	J01600000056			1	
30	轴用弹性挡圈	cir clip	J0150000412R		Ø8	1	
31	线卡	cabl e hook	02567411H33R	PA6-GF30		1	
32	左装饰片	Left decorate cover	0195D30A613	ABS		1	
33	上盖	cover	0195614PH02	PP		1	
34	左上盖压块	Left cover washer	0195879PH02	PP		1	
35	挂线钩	hook	0440D72AH01	ABS		1	
36	十字盘头螺钉	bol t	J00100000276R		M5*16	1	
37	螺丝	bol t	J00100000056R		ST4*16	19	
38	上盖手柄盖	cover handle	0195619P613	PP		1	
39	开关盒组件	swi tchbox components	A6330870001R			1	德式
40	六角螺母	nut	J1920000000R		M5	1	
41	旋钮	knob module	0256762P860	PP		2	
42	六角螺母	nut	J0020000005R		M6	2	
43	后轮轴	rear wheel axes	J00900000291R	Q235		1	
44	草箱提手	grassbox handle	0636D86PH02	PP		1	
45	草箱提手盖	grassbox handle cover	0636K20PH02	PP		1	
46	保护板扭簧	spring flap	J1950360001R	70C		1	
47	保护板	cover handle cover	0195885P860	PP		1	
48	机体	deck	0195438P860	PP(AW191)		1	
49	三角板	set square	01971680H33R	PA6-GF30		2	
50	连杆	move pole	0195528AH01	ABS		1	
51	草箱	grassbox	0195D67PH02	PP(AW191)		1	
52	万颈螺栓	bol t	J0020000070R		M6*45	2	
53	草箱盖	grassbox cover	0195F44P860	PP(AW191)		1	
54	草满指示板	grass show	0197807P874	PP		1	

四轮割草机爆炸图

LM-C3805

设计	审核	日期	日期	苏州金莱克精密机械有限公司
----	----	----	----	---------------